

# EMI THUNDER PLUMBING

## EMI-131 BYPASS "Y"

### STOCK MERCURY PLUMBING

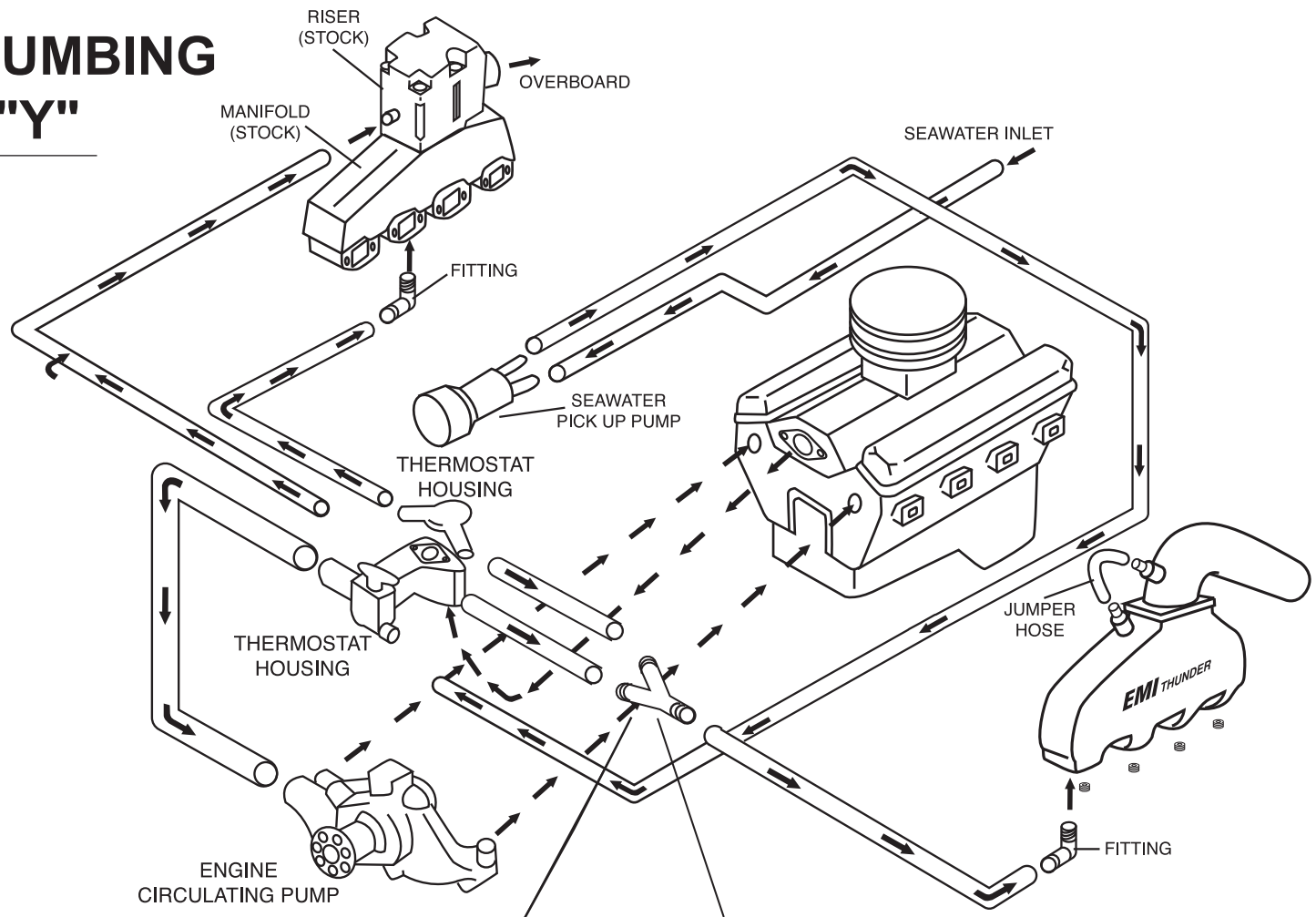

ENGINE  
CIRCULATING PUMP

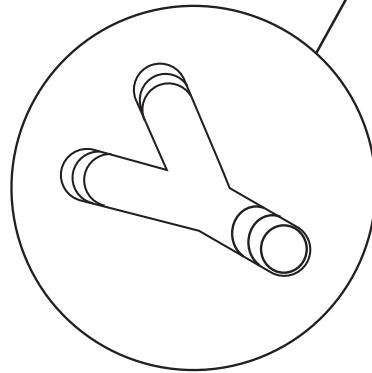

**EMI-131 BYPASS "Y" FITTING FOR 1" HOSE; TWO OF THESE ARE REQUIRED TO CONVERT STOCK MERCUISER FOUR HOSE THERMOSTAT/COOLING SYSTEMS TO EMI THUNDER TWO HOSE SYSTEM.**

With the Merc system, before the engine reaches operating temperature, water is bypassed from the thermostat housing into the stock exhaust riser through two of the hoses. The other two hoses are for the engine discharge water that goes to the bottom of the Merc exhaust manifold. When using EMI Thunder manifolds, the bypass "Y" fittings will route both the bypass and discharge water hoses to the bottom of the EMI manifold.